



6016-Z Deep groove ball bearings

- SKF Explorer

Deep groove ball bearings

Bearing data

[Tolerances](#),

Normal (metric), P6, P5, Normal (inch),

[Radial internal clearance](#),

Matched bearing pairs, Stainless steel
d < 10 mm, Other bearings

Bearing interfaces

[Seat tolerances for standard conditions](#),

[Tolerances and resultant fits](#)

Technical specification

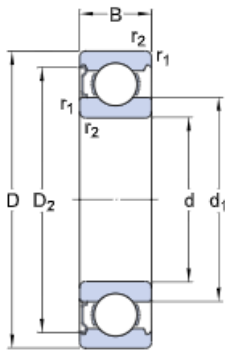

DIMENSIONS

d	80 mm	Bore diameter
D	125 mm	Outside diameter
B	22 mm	Width
d ₁	≈ 94.4 mm	Shoulder diameter
D ₂	≈ 114.1 mm	Recess diameter
r _{1,2}	min. 1.1 mm	Chamfer dimension

ABUTMENT DIMENSIONS

d _ε min.	86 mm	Diameter of shaft abutment
d _ε max.	94.3 mm	Diameter of shaft abutment
D _i max.	119 mm	Diameter of housing abutment
r _a max.	1 mm	Radius of shaft or housing fillet

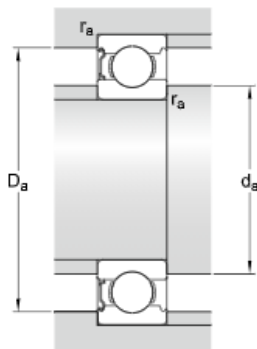

CALCULATION DATA

C	49.4 kN	Basic dynamic load rating
C ₀	40 kN	Basic static load rating
P _u	1.66 kN	Fatigue load limit
	11 000 r/min	Reference speed
	7 000 r/min	Limiting speed
k _r	0.025	Minimum load factor
f ₀	15.6	Calculation factor

MASS

	0.87 kg	Mass bearing
--	---------	--------------

TOLERANCE CLASS

P6	Dimensional tolerances
Normal	Radial run-out